

## Cooling



COTB 0001

# FWP1113/FWP1696

## Heavy Duty Water Pump Options

First Line is able to offer optional updated/heavy duty Water Pumps for VAG applications listed as **FWP1113** (Pump only) / **FWP1696** (inc. Backhousing).

These premium pumps are manufactured to exacting Original Equipment specification incorporating a new 4 point angular contact bearing and a silicon carbide seal.

**FWP1113** & **FWP1696** remain available and unaffected by this option.

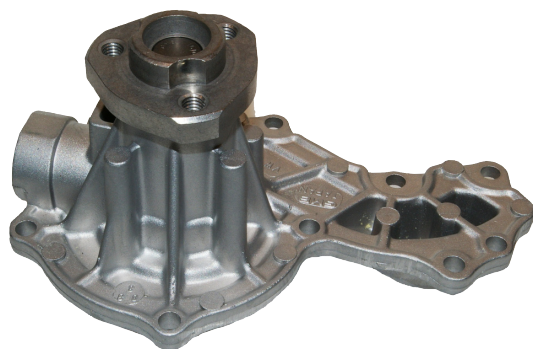

### FWP2074

Pump Only  
OE ref: 037 121 010C  
Optional fitment for FWP1113



### FWP2075

Pump with backhousing  
OE ref: 037 121 010C  
Optional fitment for FWP1696

**FIRST LINE**   
THE ALL MAKES SPECIALIST

[www.firstline.co.uk](http://www.firstline.co.uk)

TECHNICAL INFORMATION