

## OPEL / SUZUKI / VAUXHALL

Agila, Astra, Corsa, Wagon R - 1.0i X10XE / Z10XE, 1.2i X12XE / Z12XE engines

# PUMP DESIGN OPTIONS

Two different designs of Water Pump are available for the vehicles shown above. Please ensure you choose the right replacement option.

### TYPE 1



#### **FWP1787**

Pump Only (without transmitter housing)

### TYPE 2

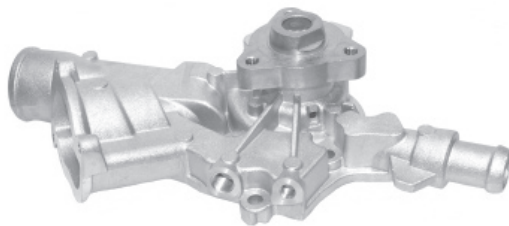

#### **FWP2078**

Pump supplied with tapped holes  
in body for Transmitter



#### **FWP2194**

as FWP2078 but complete with  
sensor unit and metal pipe connector