

Blue Print Top Tip

Rover 600 / Honda Accord, Odyssey, Prelude, Shuttle - Balance Shaft Locking Pin Screw

Applicable References: ADH25501

Applications: Rover 600 1996>1998 / Honda Accord 1990>2003, Odyssey 1994>2003, Prelude 1992>2000, Shuttle 1995>2001

Date Issued: 03/2011

Blue Print's 'Locking Pin Screw' **ADH25501** is required to allow correct alignment of the balancer shaft when replacing the timing and balancer shaft belts on many Honda models.

The balancer shaft is driven by the crankshaft via a toothed belt that needs to be removed when replacing the timing belt, and is usually replaced at the same time

ADH25501

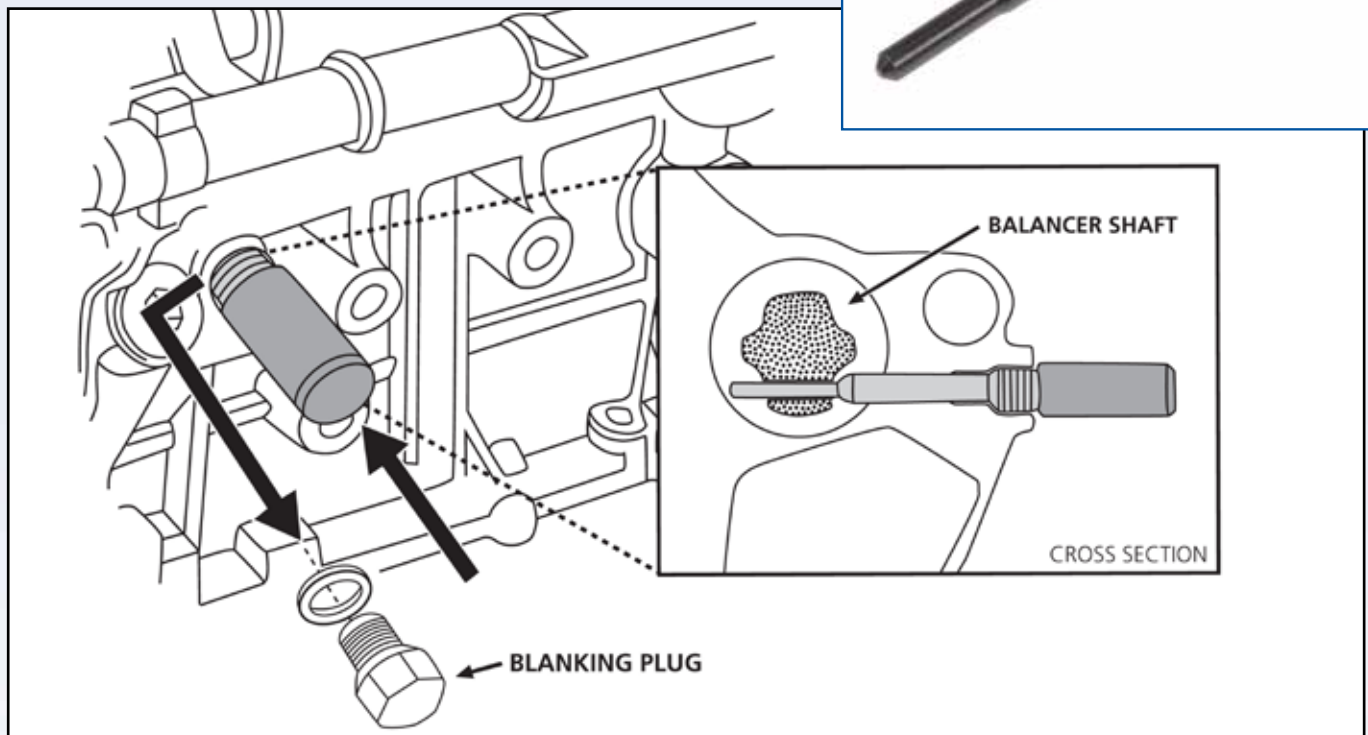

- Access for the balancer shaft locking pin screw is via a blanking plug shown above.
- Remove the plug and insert the locking pin while carefully rotating the crankshaft until the pin and shaft are correctly aligned.
- Due to the offset nature of the slot in the balancer shaft, it is not possible to fit the pin 180 degrees out.

Failure to use the correct tools and adhere to the correct instructions could result in severe engine damage.

We recommend that you do not attempt timing belt replacement unless you have the full manufacturer's instructions for performing the maintenance/repair.

Disclaimer: Any technical tips are produced in good faith. Ferdinand Bilstein UK Ltd. always recommend that vehicle maintenance and diagnostics are only carried out by suitably experienced people using appropriate tools in a safe manner within a workshop environment. Ferdinand Bilstein UK Ltd. and their customers cannot be held responsible for the correctness of, or misinterpretation of the above technical tips. Images shown are for illustrative purposes only and may not be representative of the products or vehicles described.



www.blue-print.com

Blue Print is a bilstein group brand