

## Draining the battery cooling system

1. Perform the steps in Before all workshop operations; see Procedures for all workshop operations on hybrid vehicles.
2. Open the hatches.

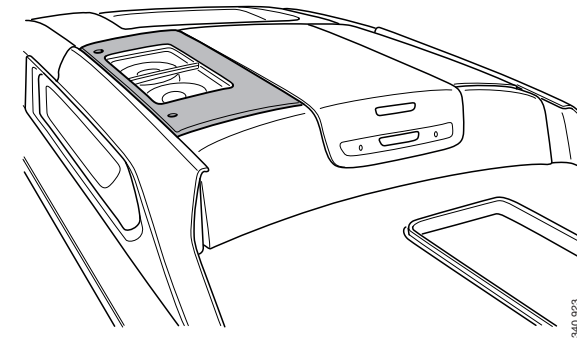

3. Remove the cap on the expansion tank for the battery cooling system.

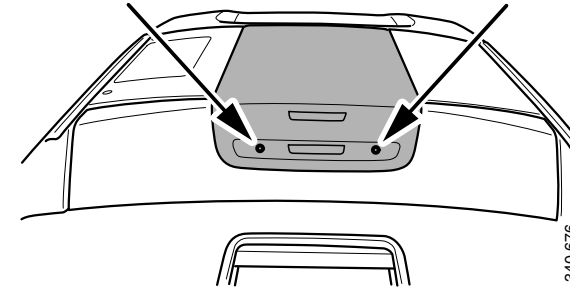
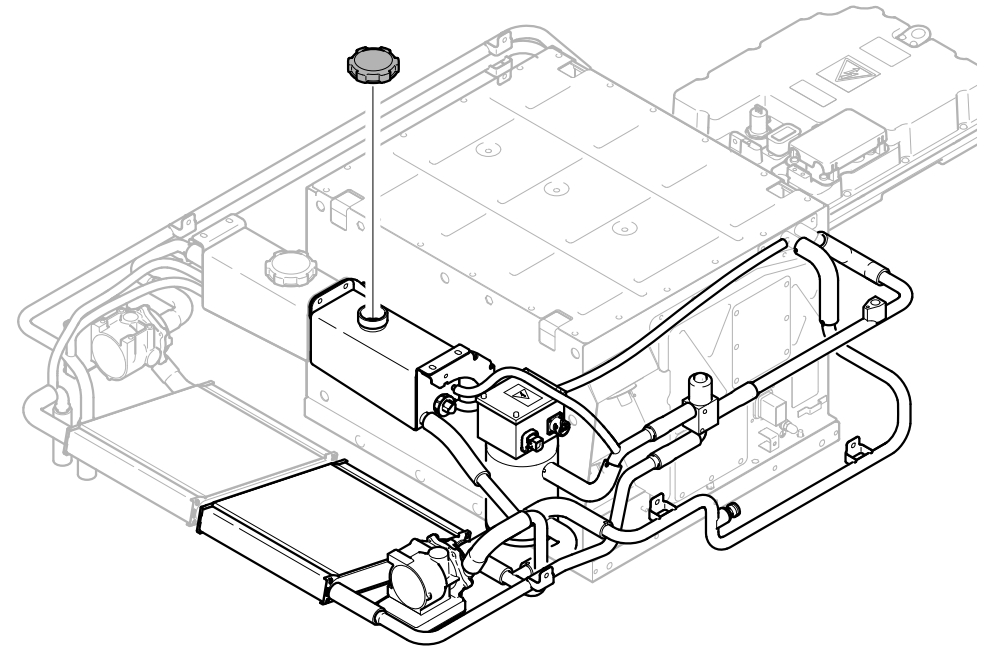

4. Connect the coolant trolley so that it is possible to drain the coolant.
  - Detach the pump's suction hose from the coolant reservoir.
  - Connect the pump pressure line to the coolant reservoir.
5. Connect the coolant trolley to the system's coolant connection.
6. Drain the coolant with the coolant trolley.

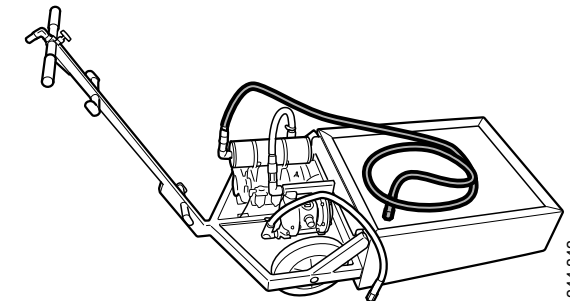
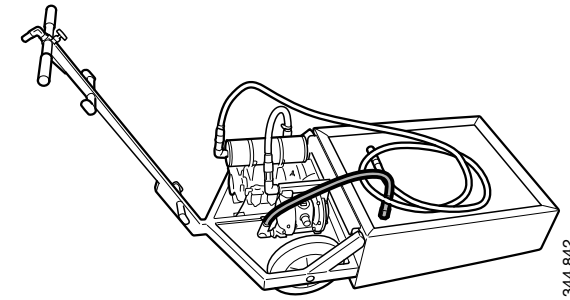

## Draining the inverter and rectifier cooling system

1. Perform the steps in Before all workshop operations; see Procedures for all workshop operations on hybrid vehicles.
2. Remove the cap on the expansion tank for the inverter cooling system.
3. Connect the coolant trolley to the system's coolant connection.
4. Drain the coolant with the coolant trolley.

