

General

Applies to 9, 11, 12 and 13 litre engines with PDE, HPI, XPI or GAS.

Tools

Examples of suitable tools from Scania:

Part number	Designation
587 470	Pin extractor

Work description

1. Drain the coolant.
2. Tilt the cab.
3. Remove the right-hand mudguard to improve access to the coolant pump.
4. Undo the auxiliary heater hose at its connection to the engine.¹
5. Slacken off the belt drive.
6. Remove the idler roller (1) and the pulley (2) to gain access to remove the coolant pump.²

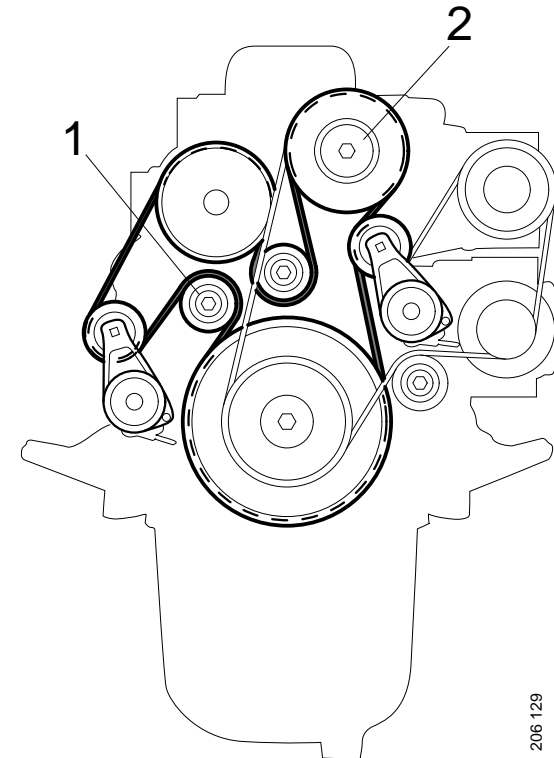

206 129

1. Vehicles with auxiliary heater
2. Engines with geared-up fan

7. Remove the cable bracket.
8. Undo and remove the pump with its housing.

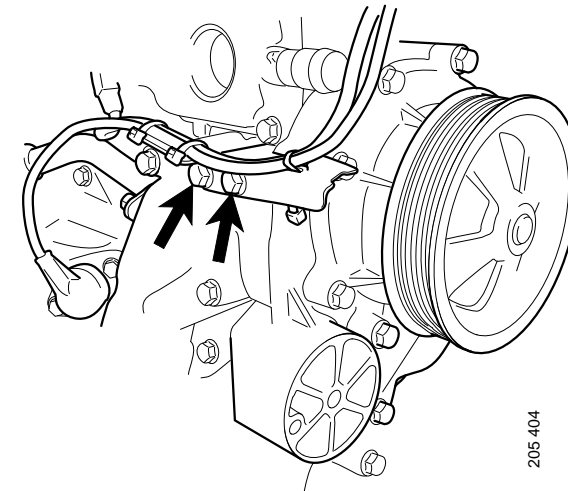

9. Remove the pump housing from the pump.

