

General

Applies to 16 litre engines with XPI and cylinder block generation 2.

Tools

Examples of suitable tools from Scania:

Part number	Designation
99 614	Lifting tool
588 955	Socket

Work description



WARNING!

- The fuel system has a very high fuel pressure of up to 3,000 bar. The fuel system must be depressurised using SDP3 before any work is started.
- The system should always be treated as pressurised, even when the engine is switched off.
- Wear protective gloves and goggles.

Preparations

- Wash the engine
- Drain the coolant
- Evacuate the pneumatic system

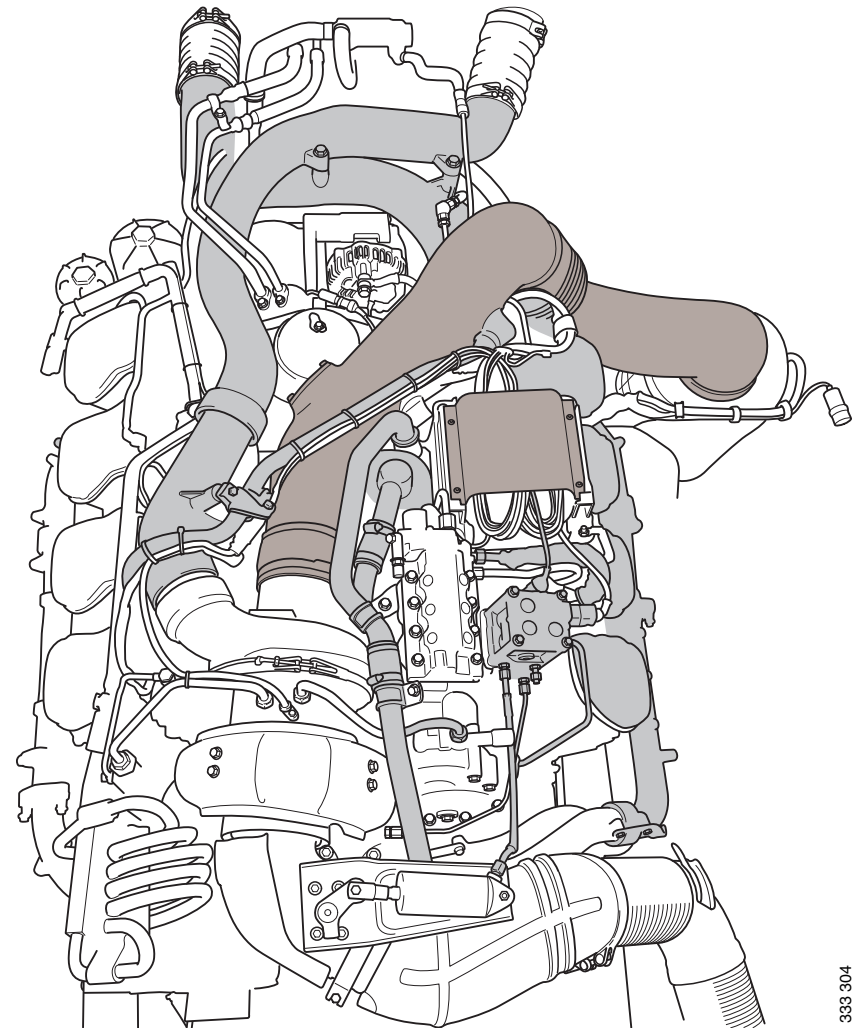

Remove the parts marked in grey

333 304

Removing various parts

Remove parts in the order below:

1. Inlet pipe between air filter and turbocharger
2. Inlet pipe to compressor
3. Control unit
4. Oil mist separator

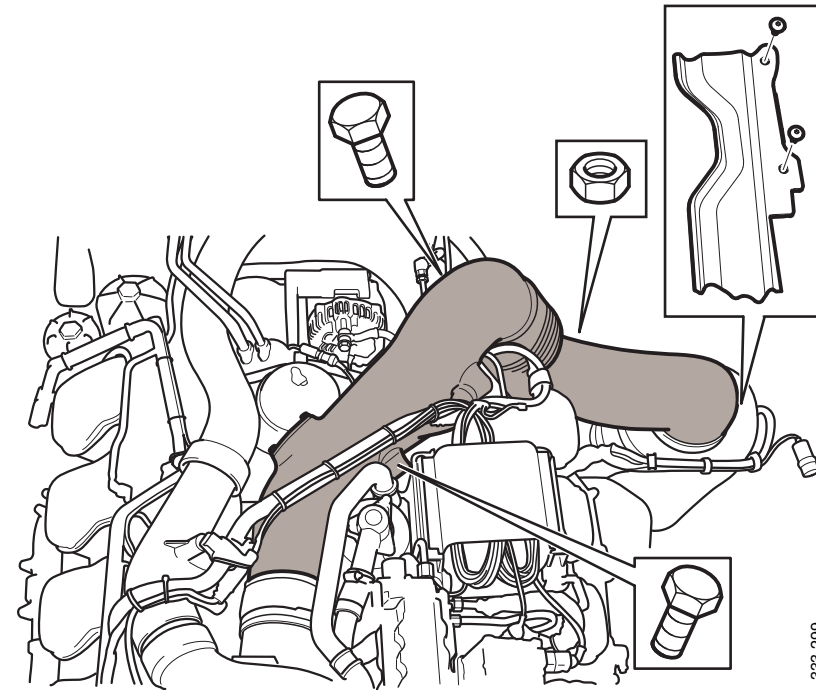

333 299

5. Connecting pipe between the intake manifolds

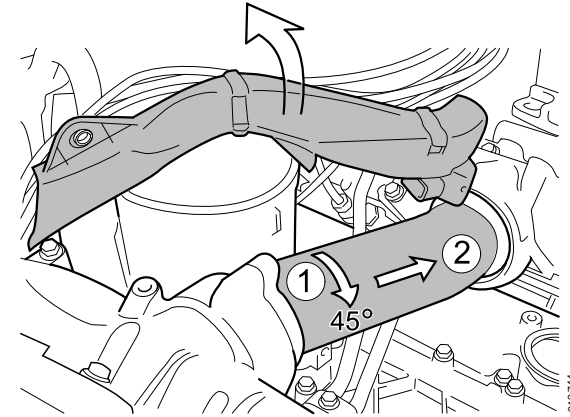

6. Bellows between charge air pipe and charge air cooler

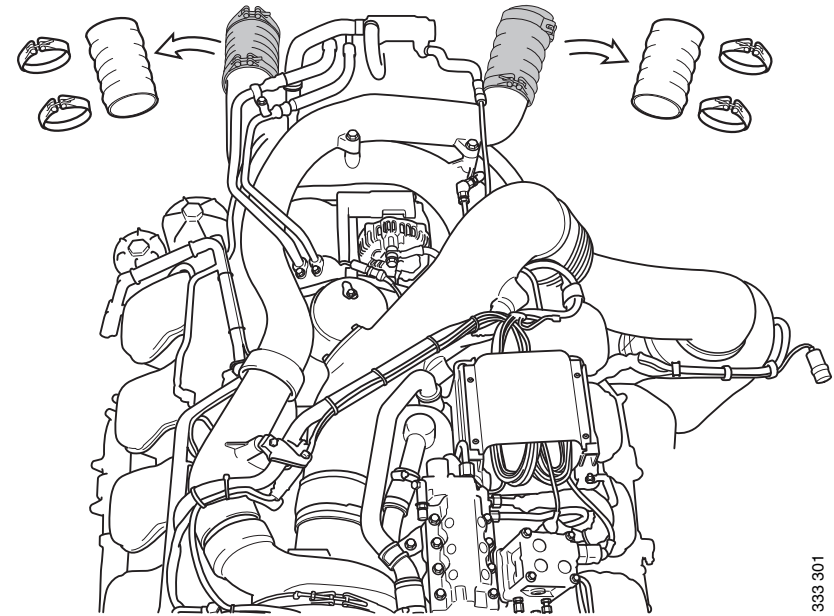

333 301

7. Charge air pipe between turbocharger and charge air cooler
8. Pipe for measurement of exhaust gas pressure
9. Valve block and pressure pipe
10. Charge air pressure sensor in intake manifold
11. Temperature sensor in charge air pipe
12. Charge air pipe to intake manifolds

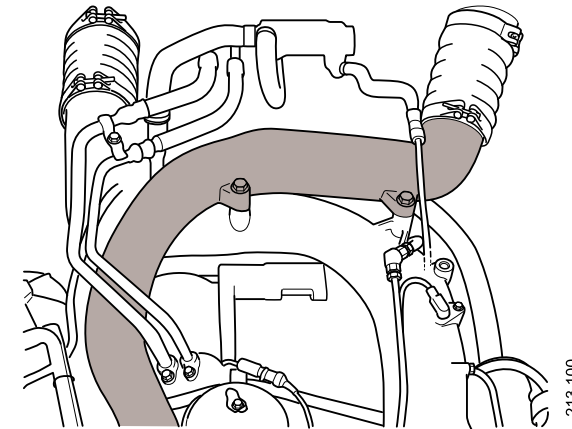

Removing the fuel system

Remove parts in the order below:

1. Test connection for fuel pressure
2. Fuel pipe between the high pressure pump and accumulator
3. Fuel pipe between the right-hand and left-hand accumulators
4. Fuel pipe between the safety valve and the high pressure pump
5. Fuel pipe between the control unit cooling coil and the high pressure pump
6. Fuel pipe between the fuel filter and the control unit cooling coil
7. Connection pipe between right-hand and left-hand fuel manifolds

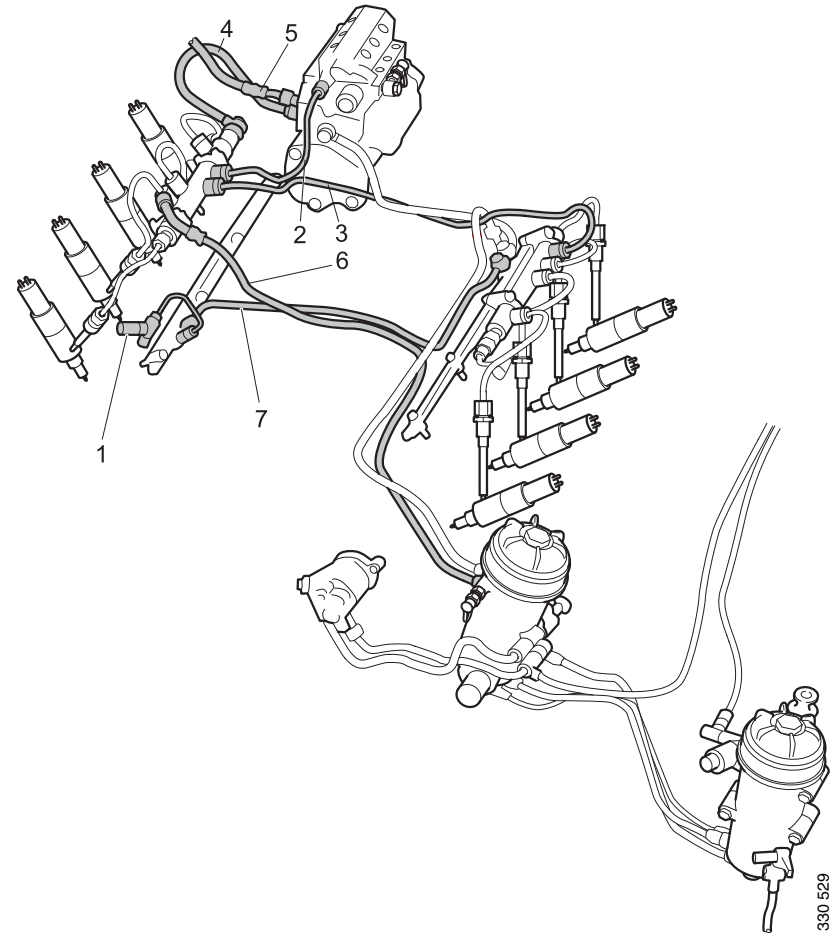

330 529

Removing the cylinder head bank

Remove parts in the order below:

1. Fuel pipes to injectors
2. Heat shield between cylinder head 3 and exhaust manifold joint
3. Exhaust manifold on right-hand cylinder head bank
4. Upper rocker cover
5. Valve mechanism
6. Cable harness and the lower rocker cover
7. Injectors

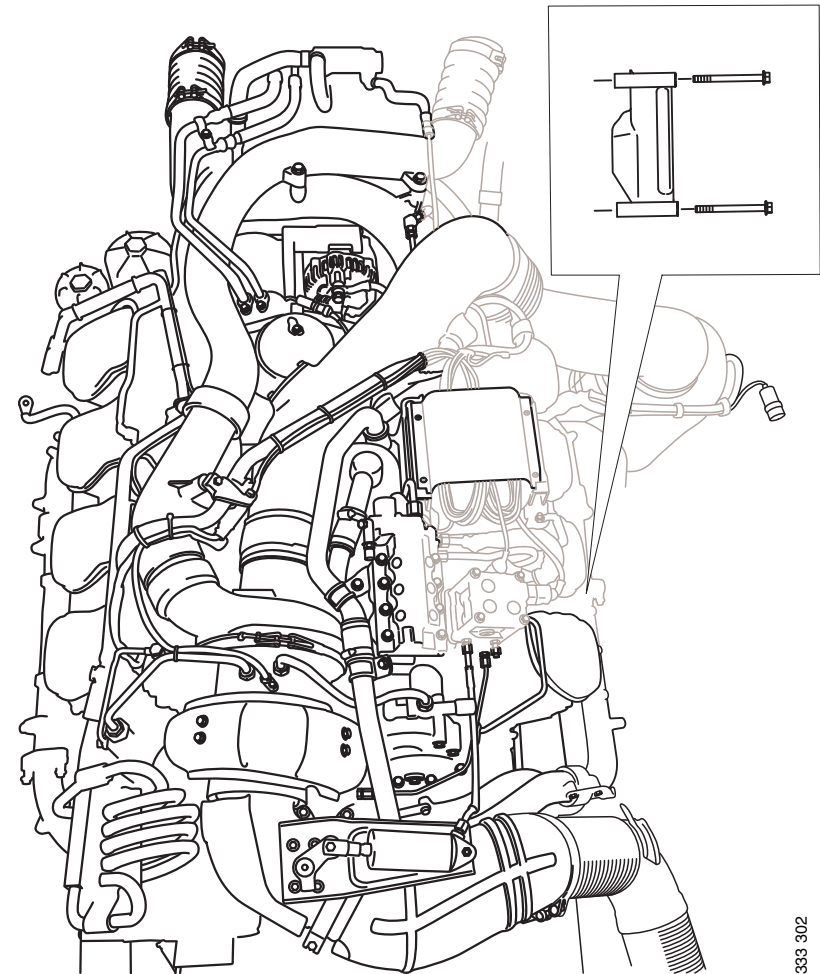

333 302

8. Fit lifting tool 99 614 for removing the cylinder head bank
9. Remove bolts on the right-hand cylinder head bank and lift off the cylinder head bank

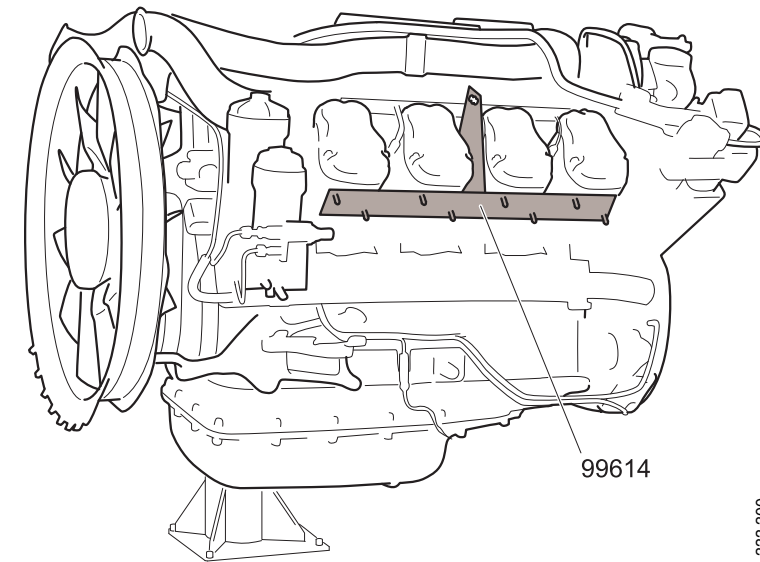

333 300